



EZ Way, Inc.

“Your Total Patient Lift Solution”

**EZ Way Stand Aid
with Moveable Legs
450 lb. Capacity**

Operator’s Instructions



EZ Way, Inc.
PO Box 89
Clarinda, IA 51632
1-800-627-8940
www.ezlifts.com

Form 2-223
Rev. 3/4/13

The affordable, durable EZ Way Stand Aid with moveable legs actively engages the patient in the standing process, thus reducing the need for caregiver assistance. Its ability to fit through narrow doorways and 450 lb. safe working load makes it an excellent wheelchair alternative for convenient patient transfers. Call EZ Way at 1-800-627-8940 to schedule a product demonstration.

The EZ Way Stand Aid is also a transfer assist unit which keeps residents active and engaged in the transferring process. Transfers are quick and require minimal caregiver assistance. Users simply grasp the middle bar and pull themselves up. A padded split seat swings out for loading or unloading then swings back and locks to form a comfortable, secure seat for transport. It is an excellent alternative to a wheelchair for easier commode access.

For safe operation of the EZ Way Stand Aid, operators should read through this manual, complete the competency checklist, and practice on fellow staff members before use with patients.

Safety Notes

The EZ Way Stand Aid is a manual standing aid to allow patients to assist themselves in preparation for transferring. Patients qualified to use the EZ Way Stand Aid should have adequate arm strength to pull themselves upward and enough leg strength to support their own weight. Patients who meet this criteria and have difficulty walking will find the EZ Way Stand Aid a useful and safe transferring device. The Stand Aid is positioned between a traditional walker and electric stand assist lift in terms of function. Once the resident has positioned themselves on board, the split seat can easily be placed securely and allow the resident to sit comfortably while a caregiver performs the transfer. For residents lacking the strength to assist themselves, an EZ Way Smart Stand or EZ Way Smart Lift is recommended.

The EZ Way Stand Aid is capable of the following transfers when used according to the instructions:

- 1) Bed to Chair/Wheelchair
- 2) Bed/Chair/Wheelchair to commode
- 3) Room to Room

These instructions should be kept with the EZ Way Smart Stand Aid at all times. Instructions can also be downloaded from EZ Way's website www.ezlifts.com.

DO NOT:

- use without complete understanding of the safe and correction operation
- use for the purpose of transportation over long distances
- use for the purpose of seating over long periods of time

⚠ WARNING:

Failure to use this device according to instructions may cause serious injury.

⚠ WARNING:

Never attempt to transfer a patient whose weight exceeds 450 lbs.

Specifications

SPECIFICATIONS	
Capacity:	450 lbs. (205 kg)
Unit Weight:	60 lbs. (27 kg)
Minimum Base Width:	26.8" (68 cm)
Maximum Base Width:	37"* (94 cm)
Open Base Width:	37"* (94 cm)
Closed Base Width:	26.7" (67.8 cm)
Overall Height:	43.3" (110 cm)
Base Height:	4.5" (11.4 cm)
Minimum Seat Height:	26.7"*** (67.8 cm)
Seat Width:	20" (50.8 cm)
Overall Length:	35.4" (90 cm)
Shin Guard/Knee Pads:	Yes
Optional Support Strap:	Yes
Seat Locks:	Yes

* Measured to the outside of each base leg with the base legs in the widest option position.

** Measured from the ground to the bottom of the seat.

Assembly

Parts List		
No.	Description	Quantity
1.	Cross Bar	1
2.	Right Side Arm	1
3.	Left Side Arm	1
4.	Side Support Arm	2
5.	Knee Pad Support Bar	1
6.	Knee Pad	2
7.	Seat	2

Tools & Fasteners		
No.	Description	Quantity
A1	Carriage Bolt	8
A2	Hex Bolt	2
A3	Hex Screw	4
A4	Washer	10
A5	Lock Washer	10
A6	Lock Nut	10
A7	Plastics Cap	2
T1	Wrench	1
T2	Allen Key	1

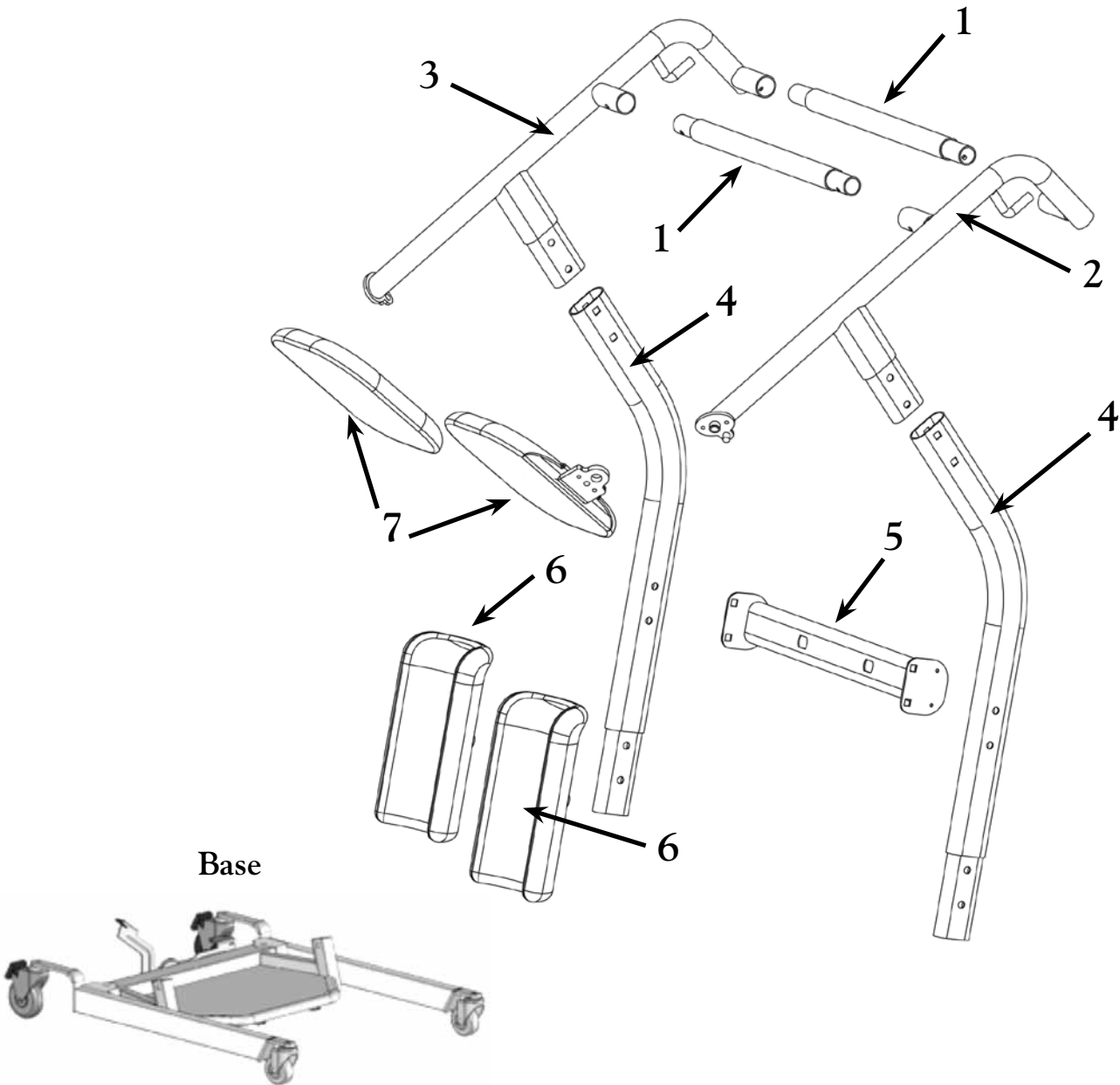

Step-by-Step Assembly

1) Place the base assembly on the floor and lock the back casters for ease of assembly.

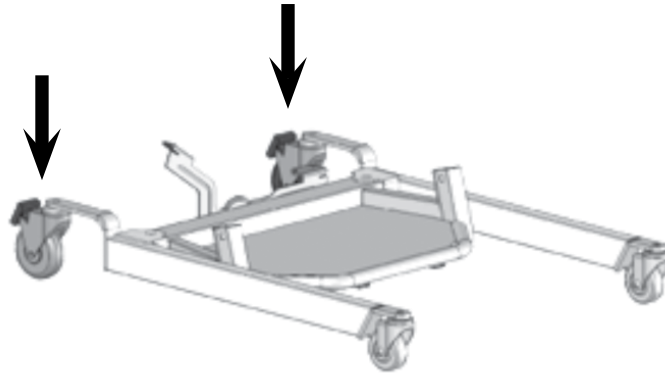

2) Insert the kneepads into the support bar and secure them in place with bolts and washers (A2 + A5 + A4) as indicated below.

Cover the two bolt heads with black plastic caps (A7) to complete kneepad assembly.



3) Install the kneepad assembly between the two side support arms as shown. Fasten in place with four carriage bolts, nuts and washers.

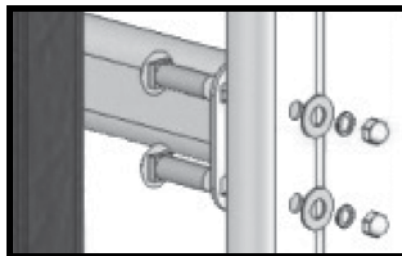

4) Insert the two cross bars into the holes on the seat and handle bar support units. Line up the small holes on the underside of the tubes with the holes in the support units. Use the 4 hex screws (A3) with Allen key (T2) to tighten the completed assembly.



5) Insert the kneepad side support assembly into the base slots and then insert the seat assembly into the kneepad and side support assembly.

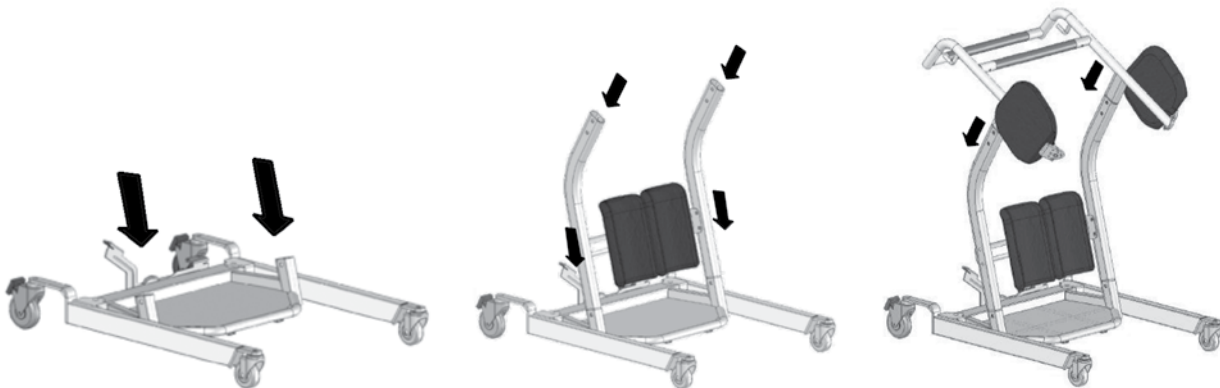

6) Use the remaining 4 carriage bolt assemblies to securely fasten the two sub assemblies to the base unit. All of the square shoulders of the bolts should be on the inside and the washers and lock nuts on the outside (A1 + A4 + A5 + A6).

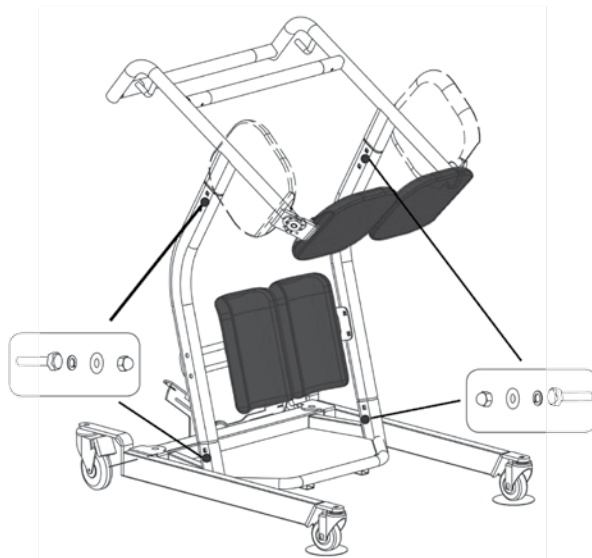

Seat Usage Instructions

The two black molded seat units can be rotated upwards to allow for patient loading. Once the patient is in an upward standing position the split seats must be lowered down to form a complete two-sided seat. Always make sure each of the two seat components are properly lowered forming a complete seat prior to having the patient sit down.

- 1) Unlock and raise the two split seat units up and parallel to the side of the unit as shown below.

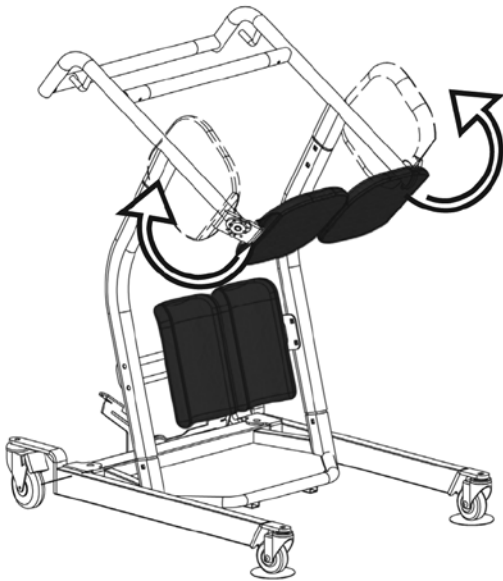

- 2) Have the patient positioned at the edge of the surface and move the standing transfer aid in front of the patient so that their feet are firmly on the platform and knees/shins are in contact with the two cupped knee/shin pads as shown below. The EZ Way STA 450 allows access



around wider obstacles such as recliners. The base of the EZ Way STA 450 opens by stepping the foot pedal.

- 3) Lock the casters by stepping on the caster clip and pushing down as shown below.
- 4) Have the patient grasp the cross bar closest

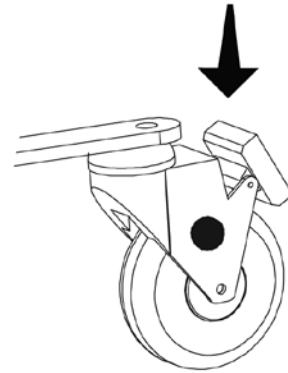

to them and using their own strength pull themselves up into a standing position firmly on the platform as shown.

- 5) Lower both of the split seat units down into



position to form a complete seat as shown.

6) Have the patient lower themselves down onto



the seat while keeping their knees/shins in the knee/shin pads and holding the cross bar with both hands as shown.

7) Unlock the casters and place both hands on the



cross bar furthest from the patient and move the standing transfer aid to the new surface. Make sure the patient is secure and in proper position as described in Step 6 prior and during transfer as shown below.



Accessories

The EZ Way Stand Aid is designed to fully support a seated patient for transfer. For patients requiring some upper body support or additional security, a safety belt may be used. Please see the pictures below for the use of these slings:



Maintenance

The EZ Way Stand Aid with moveable legs is a manual unit and therefore requires minimum maintenance on an ongoing basis. However to ensure safety and proper use the following steps should be taken on a monthly basis:

- 1) Check all bolt/nut assemblies to make sure they are tight and no wear and tear is evident. Replace and tighten any worn assemblies prior to using the EZ Way Stand Aid.
- 2) Check the two seat assemblies to make sure they are not worn or damaged and that the bolts are tight. Replace any worn or damaged seat components prior to using the EZ Way Stand Aid.
- 3) Check the casters to make sure they are in working order and are secured firmly to the EZ Way Stand Aid. Replace any worn or damaged casters prior to using the EZ Way Stand Aid.

LIMITED WARRANTY: EZ WAY STAND AID

The product you purchased is guaranteed by EZ Way, Inc. to be free from defects in material and workmanship under normal use and service. The warranty period for this product is twenty four (24) months from the date of purchase by the original purchaser. EZ Way agrees to repair or replace this product, at our option and at no charge, within the warranty period and proven by EZ Way's consent to be defective. For warranty service, please contact EZ Way, Inc. at 800-627-8940. To ensure the best service to our customers, EZ Way requests the following information to be included with the returned unit:

- 1) Model Name/Number and Serial Number attached on the packaging.
- 2) A detailed description of the problem and its symptoms.

This warranty shall not apply to any product which has been repaired or altered in any way so as, in our judgment, to affect its functionality and durability, nor to any product subject to abuse, misuse, negligence or accident, improper maintenance, improper installation, nor to any product used with other parts, components and /or accessories with quality and/or specifications incompatible with this product. This warranty shall also be voided if any required periodic maintenance, if applicable, has not been properly performed on this product.

EZ Way Stand Aid Competency Checklist

Purpose: To assist in the proper training of operating the EZ Way Stand Aid.

Staff Name: _____ Date: _____ Observed by: _____

Yes No

- | | | |
|--------------------------|--------------------------|--|
| <input type="checkbox"/> | <input type="checkbox"/> | a) Demonstrate how to approach the patient with the unit and direct them to place their feet on the footplate and their hands on the grasp bar. |
| <input type="checkbox"/> | <input type="checkbox"/> | b) Demonstrate how to direct the patient to raise themselves high enough so that the seat pads can be swung into place below the patient's buttocks. |
| <input type="checkbox"/> | <input type="checkbox"/> | c) In seating the patient onto a surface such as a wheelchair or toilet, demonstrate how to direct the patient to raise themselves off the seat pads and how to unlock the seat locks. |
| <input type="checkbox"/> | <input type="checkbox"/> | d) Demonstrate how to swing the seat pads out from under the patient while the patient is above a seating surface and direct them to seat themselves. |
| <input type="checkbox"/> | <input type="checkbox"/> | e) State the weight capacity of the unit. |